

No. COMPONENTS IN ASSLY	OP1	OP2	OP3	OP4	OP5	OP6	1
1							

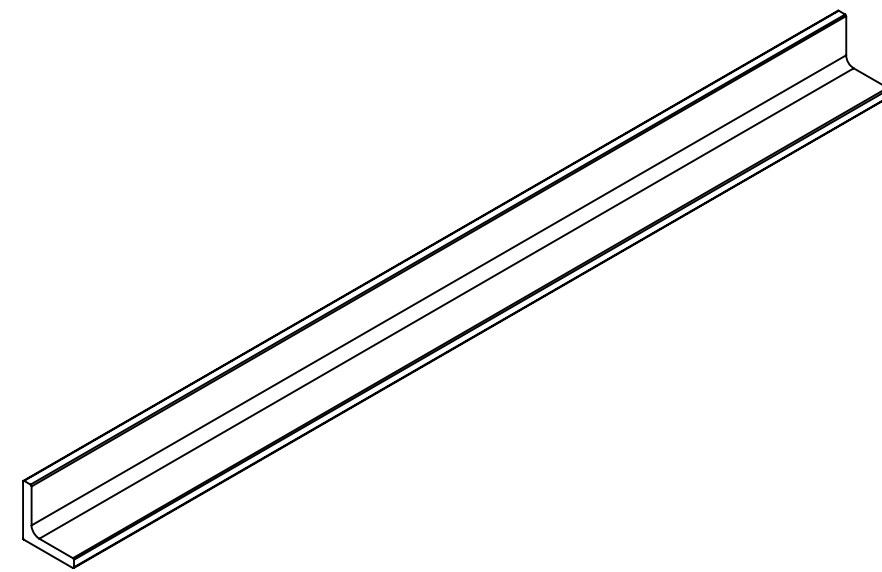
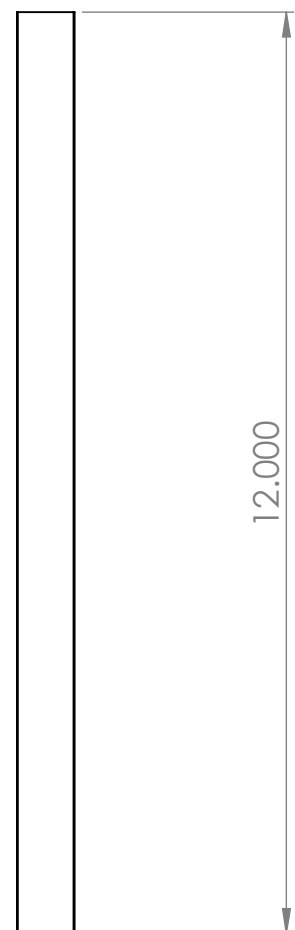
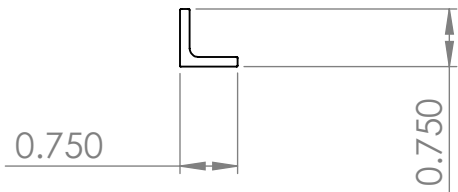

155 PRAIRIE LAKE RD, SUITE A
EAST DUNDEE, IL 60118
847.428.7122

FILE NAME 3D1-GOM-HWK-004
DIRECTORY P:\Manufacturing\PrymeFix Product Line\3DX Scanning Items\3D1-GOM-HWK-004 Angle Bar\

3D PRINTER PROPERTIES			
Material 1: N/A	<input type="checkbox"/> Support	Material 2: N/A	<input type="checkbox"/> Support
Core 1:		Core 2:	

PROPRIETARY AND CONFIDENTIAL

THE INFORMATION CONTAINED IN THIS DRAWING IS THE SOLE PROPERTY OF PRYMEFIX. ANY REPRODUCTION IN PART OR AS A WHOLE WITHOUT THE WRITTEN PERMISSION OF PRYMEFIX IS PROHIBITED.

1
2
3
4
5
6
7

UNLESS OTHERWISE SPECIFIED	
FRACTIONAL ± .003 ANGULAR: ± 1.0 TWO PLACE DECIMAL ± .010 THREE PLACE DECIMAL ± .003 FOUR PLACE DECIMAL ± .0005 (REAM)	
HEAT TREAT N/A	No Pcs to Complete Order:
MATERIAL Aluminum	
FINISH Black Anodized	

DRAWN BY:	DATE 12/31/2018
TITLE:	
SIZE B	DWG. NO. 3D1-GOM-HWK-004-TECHNICAL_DWG
SCALE: 1:5	WEIGHT:
SHEET 1 OF 1	