

3D4-GOM-HWK-000 Hawk Starter Kit

Included Items

Prymetech Part Number	Description	Quantity	Link
3D1-GOM-HWK-001	Target Pyramid	8	https://www.prymefix.com/home/3d-scanner-consumables/target-pyramid/
3D1-GOM-HWK-002	Hexagonal Target Block	9	https://www.prymefix.com/home/3d-scanner-consumables/hexagonal-target-block/
3D1-GOM-HWK-003	Tweezer Target Clamp	1	https://www.prymefix.com/home/3d-scanner-consumables/tweezer-target-clamp/
3D1-GOM-HWK-004	Targeted Angle Bar	6	https://www.mcmaster.com/6941T11/
3D2-GOM-HWK-002	Hawk Holder	1	https://www.prymefix.com/home/3d-scanner-consumables/t-hawk-scanner-holster/
3D3-GOM-HWK-001	Turntable Top (Ø8in)	1	https://www.mcmaster.com/acetal/color~black/wear-resistant-easy-to-machine-acetal-rods-and-discs/
3D5-3SS-MRK-03960	3mm Target	960 per box	https://www.prymefix.com/home/3d-scanner-consumables/reference-markers/
3D5-3SS-MRK-06960	6mm Target	960 per box	https://www.prymefix.com/home/3d-scanner-consumables/reference-markers/
---	Pelican Case	1	

8	7	6	5	4	3	2	1
No. COMPONENTS IN ASSLY	OP1	OP2	OP3	OP4	OP5	OP6	

1

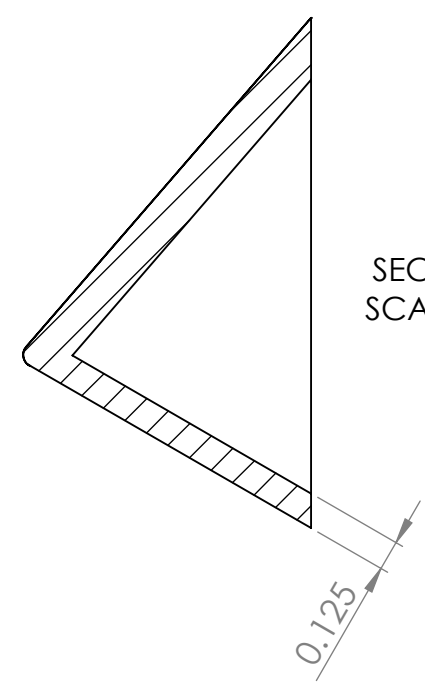
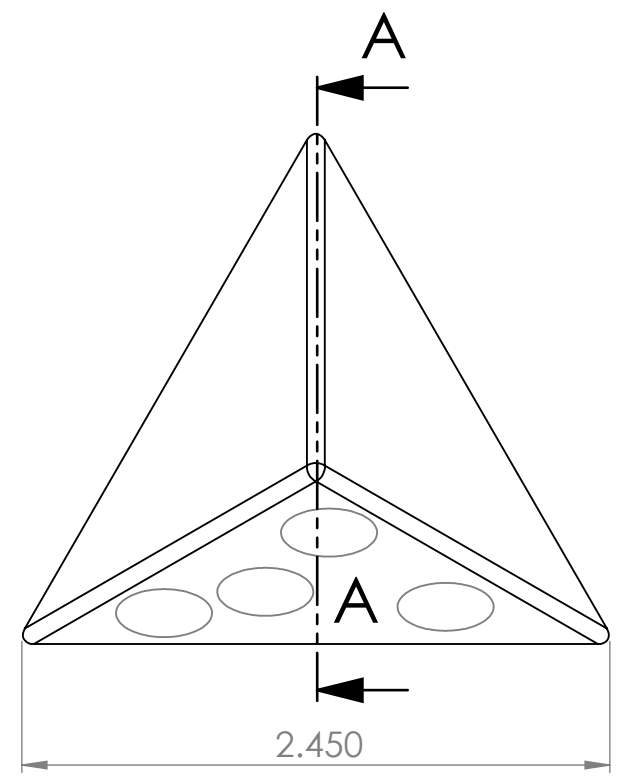

SECTION A-A
SCALE 1.25 : 1

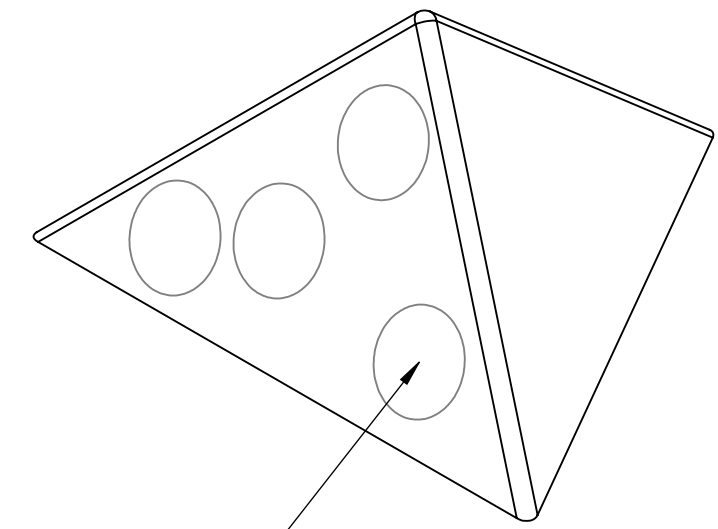

REFERENCE MARKERS

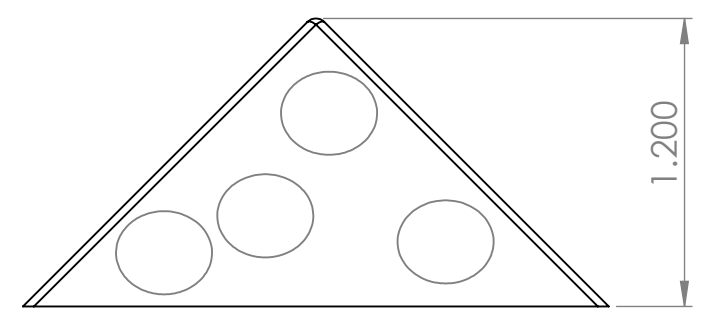

155 PRAIRIE LAKE RD, SUITE A
EAST DUNDEE, IL 60118
847.428.7122

FILE NAME
3D1-GOM-HWK-001

DIRECTORY
P:\Manufacturing\PrymeFix Product Line\3DX Scanning Items\3D1-GOM-HWK-001 Pyramid\

3D PRINTER PROPERTIES			
Material 1:	<input type="checkbox"/> Support	Material 2:	<input type="checkbox"/> Support
Rizium ST		N/A	
Core 1:	N/A	Core 2:	N/A

PROPRIETARY AND CONFIDENTIAL

THE INFORMATION CONTAINED IN THIS DRAWING IS THE SOLE PROPERTY OF PRYMETECH. ANY REPRODUCTION IN PART OR AS A WHOLE WITHOUT THE WRITTEN PERMISSION OF PRYMETECH IS PROHIBITED.

1	
2	
3	
4	
5	
6	
7	

REVISION HISTORY

UNLESS OTHERWISE SPECIFIED	
FRACTIONAL ± .003 ANGULAR: ± 1.0 TWO PLACE DECIMAL ± .010 THREE PLACE DECIMAL ± .003 FOUR PLACE DECIMAL ± .0005 (REAM)	
HEAT TREAT	N/A
MATERIAL	Rizium ST
FINISH	N/A

MACHINING PROPERTIES

INCH UNITS

DRAWN BY:	JO	DATE	4/20/2021
TITLE:			
PT PYRAMID			
SIZE	DWG. NO.	REV	
B	3D1-GOM-HWK-001_TECHNICAL_DWG	0	
SCALE: 1:1	WEIGHT:	SHEET 1 OF 1	

8	7	6	5	4	3	2	1
No. COMPONENTS IN ASSLY 1	OP1	OP2	OP3	OP4	OP5	OP6	

MAGNET FOR MAGNETIC ADHESION TO APPLICABLE PARTS

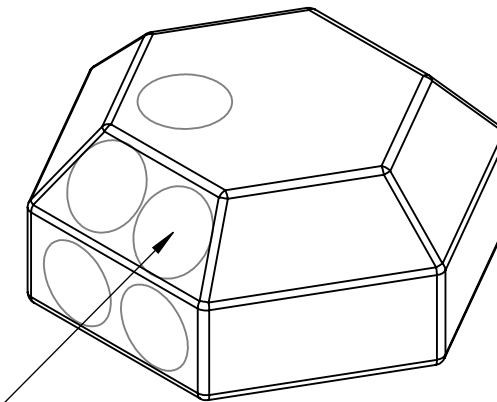
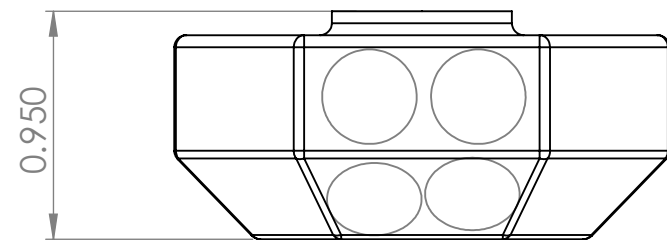
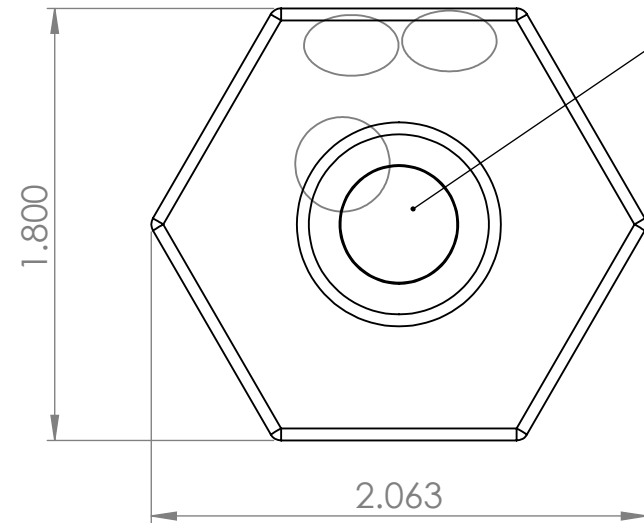

REFERENCE MARKERS



155 PRAIRIE LAKE RD, SUITE A
EAST DUNDEE, IL 60118
847.428.7122

FILE NAME
3D1-GOM-HWK-002
DIRECTORY
P:\Manufacturing\PrymeFix Product Line\3DX Scanning Items\3D1-GOM-HWK-002 Hexagonal Block\

3D PRINTER PROPERTIES			
Material 1:	<input type="checkbox"/> Support	Material 2:	<input type="checkbox"/> Support
Rizium ST			
Core 1:		Core 2:	

PROPRIETARY AND CONFIDENTIAL

THE INFORMATION CONTAINED IN THIS DRAWING IS THE SOLE PROPERTY OF PRYMEFIX. ANY REPRODUCTION IN PART OR AS A WHOLE WITHOUT THE WRITTEN PERMISSION OF PRYMEFIX IS PROHIBITED.

1	
2	
3	
4	
5	
6	
7	

UNLESS OTHERWISE SPECIFIED	
FRACTIONAL $\pm .003$ ANGULAR: ± 1.0 TWO PLACE DECIMAL $\pm .010$ THREE PLACE DECIMAL $\pm .003$ FOUR PLACE DECIMAL $\pm .0005$ (REAM)	
HEAT TREAT	N/A
MATERIAL	Rizium ST
FINISH	N/A
No Pcs to Complete Order:	

DRAWN BY:	JO	DATE	2/21/2022
TITLE: PT_MAGNETIC HEX ASSEMBLY			
SIZE	DWG. NO.	REV	
B	3D1-GOM-HWK-002_TECHNICAL_DWG	0	
SCALE: 2:1	WEIGHT:	SHEET 1 OF 1	

8	7	6	5	4	3	2	1
No. COMPONENTS IN ASSLY 1	OP1	OP2	OP3	OP4	OP5	OP6	

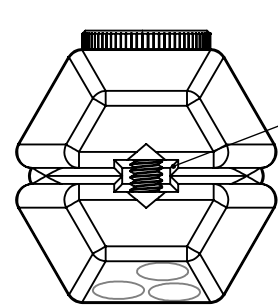

TWEEZER COMPARTMENT

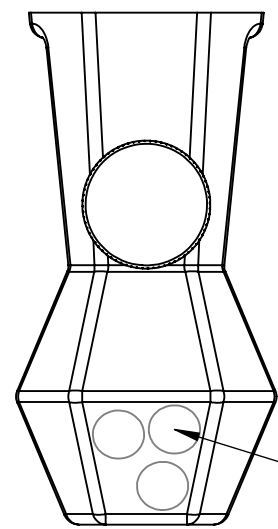

THUMB SCREW TO APPLY FORCE HOLDING TWEEZERS

REFERENCE MARKERS

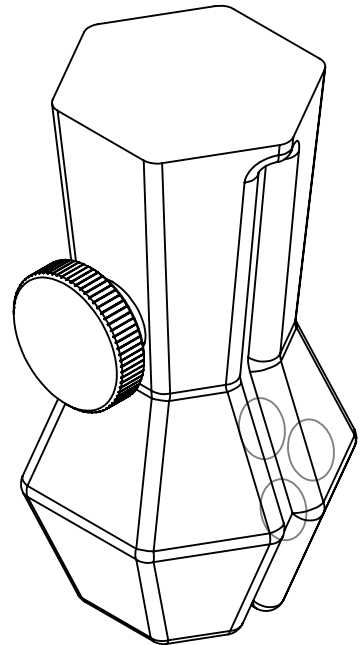
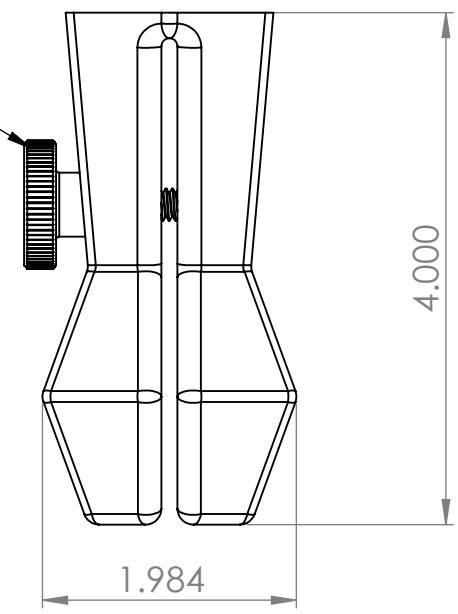

155 PRAIRIE LAKE RD, SUITE A
EAST DUNDEE, IL 60118
847.428.7122

FILE NAME 3D1-GOM-HWK-003	3D PRINTER PROPERTIES	PROPRIETARY AND CONFIDENTIAL THE INFORMATION CONTAINED IN THIS DRAWING IS THE SOLE PROPERTY OF PRYMETECH. ANY REPRODUCTION IN PART OR AS A WHOLE WITHOUT THE WRITTEN PERMISSION OF PRYMETECH IS PROHIBITED.	
DIRECTORY P:\Manufacturing\PrymeFix Product Line\3DX Scanning Items\3D1-GOM-HWK-003 Tweezer Target Clamp\	Material 1: <input type="checkbox"/> Support Rizium ST		Material 2: <input type="checkbox"/> Support
	Core 1:		Core 2:

1
2
3
4
5
6
7

UNLESS OTHERWISE SPECIFIED	
FRACTIONAL ± .003 ANGULAR: ± 1.0 TWO PLACE DECIMAL ± .010 THREE PLACE DECIMAL ± .003 FOUR PLACE DECIMAL ± .0005 (REAM)	
HEAT TREAT N/A	No Pcs to Complete Order:
MATERIAL Rizium ST	
FINISH N/A	

DRAWN BY: JO	DATE: 4/27/2021
TITLE: PT TWEEZER CLAMP ASSEMBLY	
SIZE B	DWG. NO. 3D1-GOM-HWK-003_TECHNICAL_DWG
REV 0	
SCALE: 1:2	WEIGHT:
SHEET 1 OF 1	

8	7	6	5	4	3	2	1
No. COMPONENTS IN ASSLY	OP1	OP2	OP3	OP4	OP5	OP6	
1							

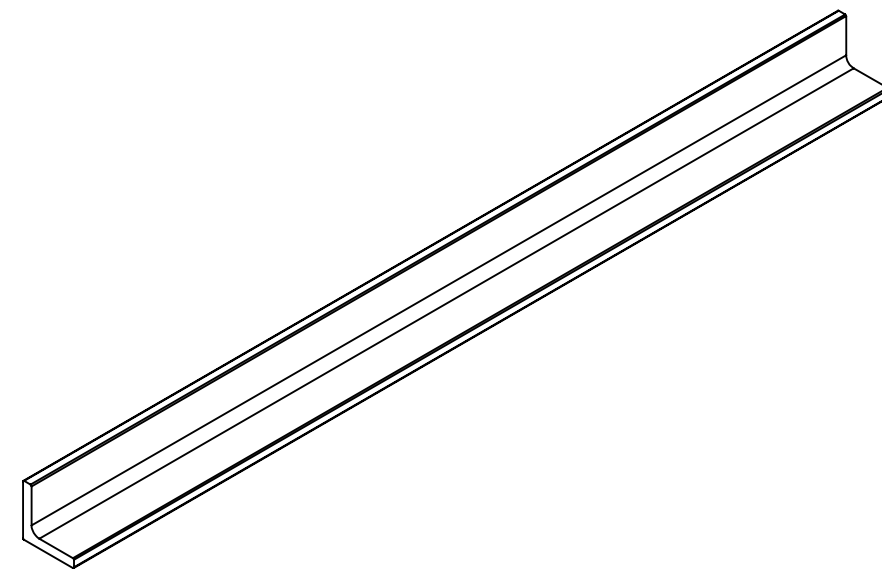
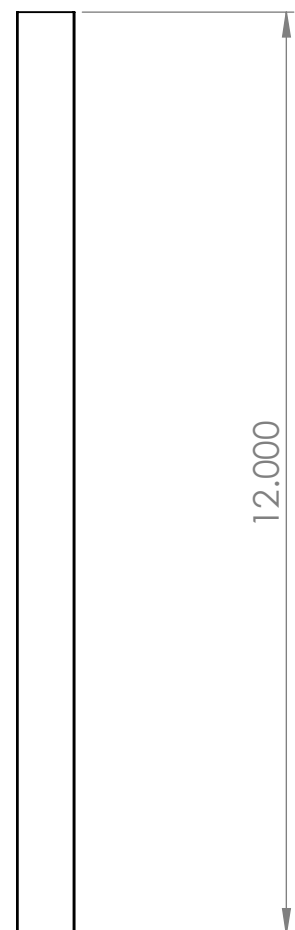
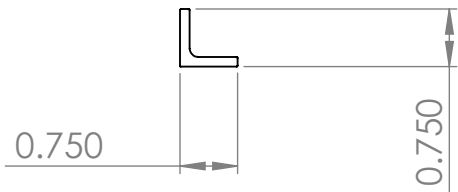

155 PRAIRIE LAKE RD, SUITE A
EAST DUNDEE, IL 60118
847.428.7122

FILE NAME 3D1-GOM-HWK-004
DIRECTORY P:\Manufacturing\PrymeFix Product Line\3DX Scanning Items\3D1-GOM-HWK-004 Angle Bar\

3D PRINTER PROPERTIES			
Material 1: N/A	<input type="checkbox"/> Support	Material 2: N/A	<input type="checkbox"/> Support
Core 1:		Core 2:	

PROPRIETARY AND CONFIDENTIAL

THE INFORMATION CONTAINED IN THIS DRAWING IS THE SOLE PROPERTY OF PRYMETECH. ANY REPRODUCTION IN PART OR AS A WHOLE WITHOUT THE WRITTEN PERMISSION OF PRYMETECH IS PROHIBITED.

1
2
3
4
5
6
7

UNLESS OTHERWISE SPECIFIED	
FRACTIONAL $\pm .003$ ANGULAR: ± 1.0 TWO PLACE DECIMAL $\pm .010$ THREE PLACE DECIMAL $\pm .003$ FOUR PLACE DECIMAL $\pm .0005$ (REAM)	
HEAT TREAT N/A	No Pcs to Complete Order:
MATERIAL Aluminum	
FINISH Black Anodized	

DRAWN BY:	DATE 12/31/2018
TITLE:	
SIZE B	DWG. NO. 3D1-GOM-HWK-004-TECHNICAL_DWG
SCALE: 1:5	WEIGHT:
SHEET 1 OF 1	

8	7	6	5	4	3	2	1
No. COMPONENTS IN ASSLY 1	OP1	OP2	OP3	OP4	OP5	OP6	

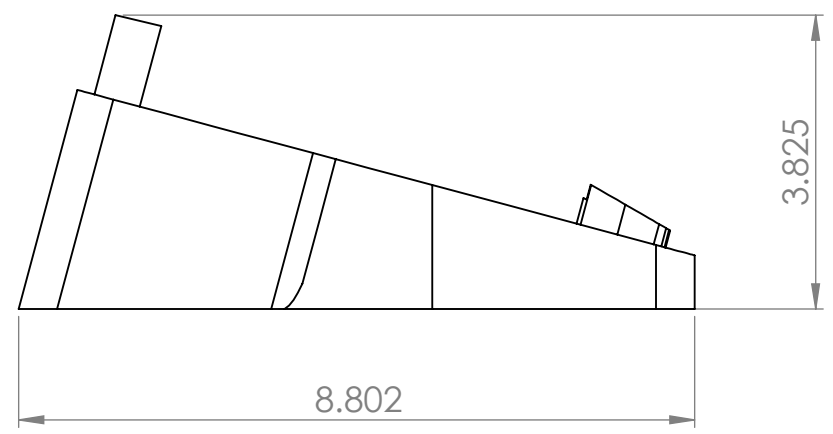
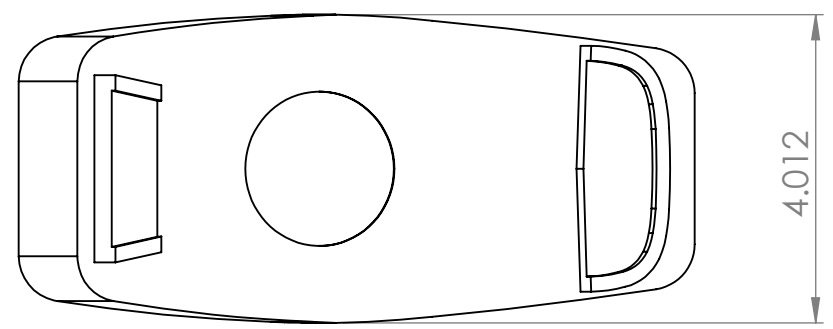

CUSTOM DESIGN FOR A PRECISION FIT

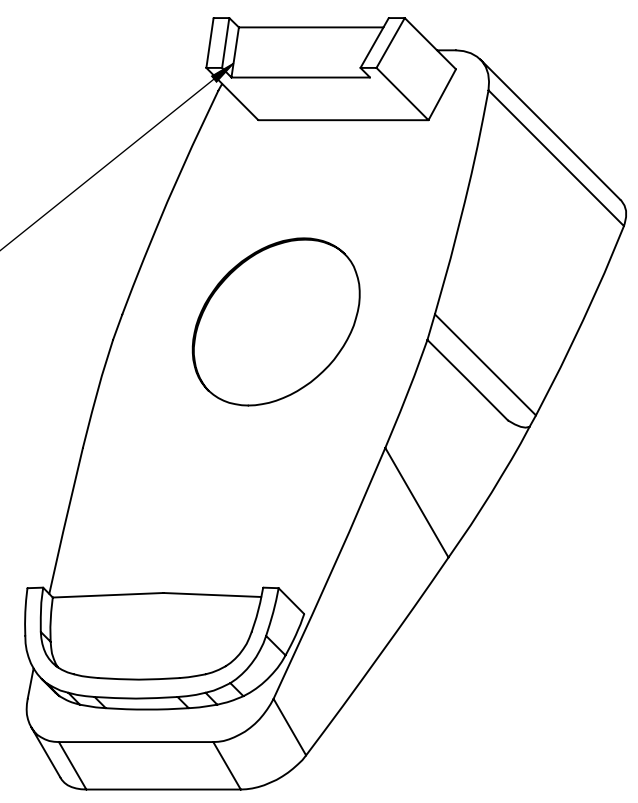

155 PRAIRIE LAKE RD, SUITE A
EAST DUNDEE, IL 60118
847.428.7122

FILE NAME 3D2-GOM-HWK-002	3D PRINTER PROPERTIES	PROPRIETARY AND CONFIDENTIAL THE INFORMATION CONTAINED IN THIS DRAWING IS THE SOLE PROPERTY OF PRYMETECH. ANY REPRODUCTION IN PART OR AS A WHOLE WITHOUT THE WRITTEN PERMISSION OF PRYMETECH IS PROHIBITED.
DIRECTORY P:\Manufacturing\PrymeFix Product Line\3DX Scanning Items\3D2-GOM-HWK-002 Holder\	Material 1: <input type="checkbox"/> Support Rizium ST	
	Material 2: <input type="checkbox"/> Support Core 1: Core 2:	

1
2
3
4
5
6
7

UNLESS OTHERWISE SPECIFIED	
FRACTIONAL ± .003 ANGULAR: ± 1.0 TWO PLACE DECIMAL ± .010 THREE PLACE DECIMAL ± .003 FOUR PLACE DECIMAL ± .0005 (REAM)	
HEAT TREAT	N/A
MATERIAL	Rizium ST
FINISH	N/A
No Pcs to Complete Order:	

DRAWN BY:	DATE 11/9/2021
TITLE:	
SIZE B	DWG. NO. 3D2-GOM-HWK-002_TECHNICAL_DWG
SCALE: 1:2	WEIGHT:
SHEET 1 OF 1	

8	7	6	5	4	3	2	1
No. COMPONENTS IN ASSLY 1	OP1	OP2	OP3	OP4	OP5	OP6	

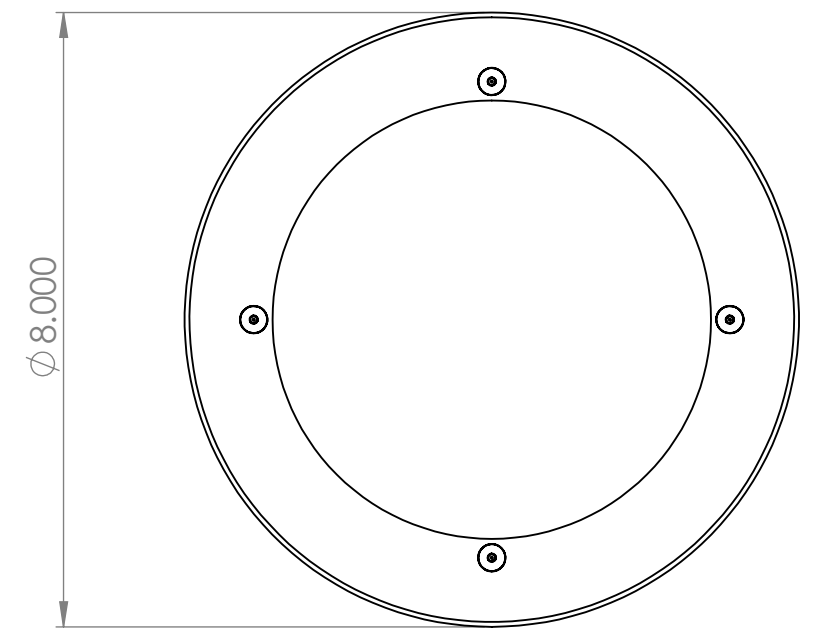
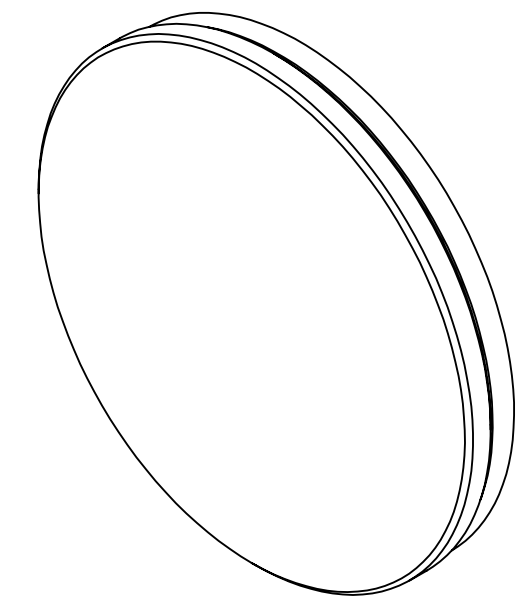
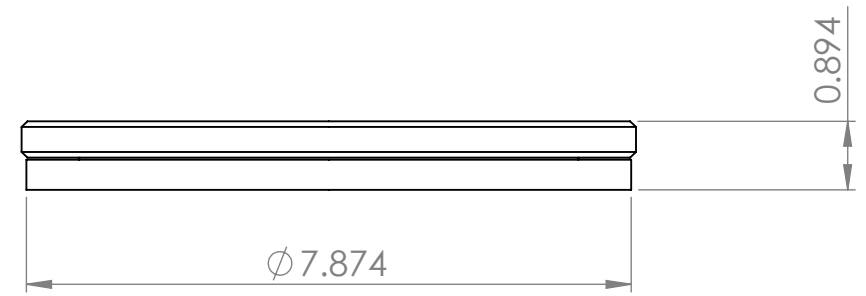

155 PRAIRIE LAKE RD, SUITE A
EAST DUNDEE, IL 60118
847.428.7122

FILE NAME
3D3-GOM-HWK-001
DIRECTORY
P:\Manufacturing\PrymeFix Product Line\3DX Scanning Items\3D3-GOM-HWK-001 Rotary Table\

3D PRINTER PROPERTIES			
Material 1: N/A	<input type="checkbox"/> Support	Material 2: N/A	<input type="checkbox"/> Support
Core 1:		Core 2:	

PROPRIETARY AND CONFIDENTIAL

THE INFORMATION CONTAINED IN THIS DRAWING IS THE SOLE PROPERTY OF PRYMETECH. ANY REPRODUCTION IN PART OR AS A WHOLE WITHOUT THE WRITTEN PERMISSION OF PRYMETECH IS PROHIBITED.

1	
2	
3	
4	
5	
6	
7	

UNLESS OTHERWISE SPECIFIED	
FRACTIONAL $\pm .003$ ANGULAR: ± 1.0 TWO PLACE DECIMAL $\pm .010$ THREE PLACE DECIMAL $\pm .003$ FOUR PLACE DECIMAL $\pm .0005$ (REAM)	
HEAT TREAT N/A	No Pcs to Complete Order:
MATERIAL Delrin & Aluminum	
FINISH N/A	

DRAWN BY:	JO	DATE	12/15/2021
TITLE: MANUAL ROTARY ASSEMBLY			
SIZE	DWG. NO.	REV	
B	3D3-GOM-HWK-001_TECHNICAL_DWG	0	
SCALE: 1:2	WEIGHT:	SHEET 1 OF 1	