

No. COMPONENTS IN ASSLY	OP1	OP2	OP3	OP4	OP5	OP6
-------------------------	-----	-----	-----	-----	-----	-----

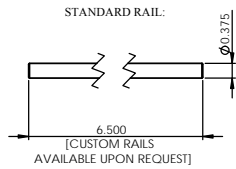
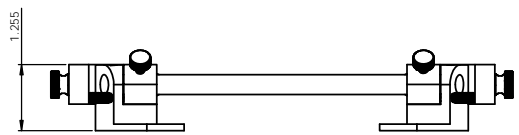
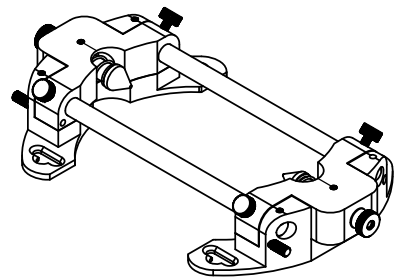
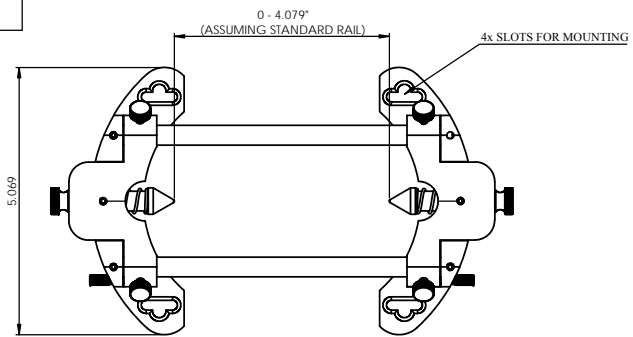

PrymeFix
 fixturing solutions

155 PRAIRIE LAKE RD, SUITE A
 EAST DUNDEE, IL 60118
 847.428.7122

PROPRIETARY AND CONFIDENTIAL

THE INFORMATION CONTAINED IN THIS DRAWING IS THE SOLE PROPERTY OF PRYMEFIX. ANY REPRODUCTION IN PART OR AS A WHOLE WITHOUT THE WRITTEN PERMISSION OF PRYMEFIX IS PROHIBITED.

1		UNLESS OTHERWISE SPECIFIED	DRAWN BY:	DATE: 6/12/2014
2		FRAC TIONAL ■ 003	TITLE: MICRO CENTERS FIXTURE ASSEMBLY	
3		ANGULAR ■ 1/10		
4		TWO PLACE DECIMAL ■ 010		
5		THREE PLACE DECIMAL ■ 003		
6		FOUR PLACE DECIMAL ■ 0005 (REAM)	SIZE: B	DWG. NO: 142-PRY-STD-001 CENTERS INSERT TECHNICAL DRAWING
7		HEAT TREAT	SCALE: 1:2	WEIGHT:
		MATERIAL	SHEET 1 OF 5	
		FINISH		
REVISION HISTORY		INCH UNITS		

FILE NAME:
 14-0331-1 CENTERS FIXTURE
 DIRECTORY
 P:\Manufacturing\Jobs\ATF\14-0331-1 CNTRS INSERT\

8	7	6	5	4	3	2	1
No. COMPONENTS IN ASSLY 1	OP1	OP2	OP3	OP4	OP5	OP6	

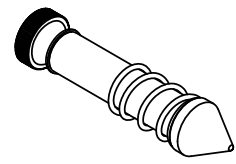
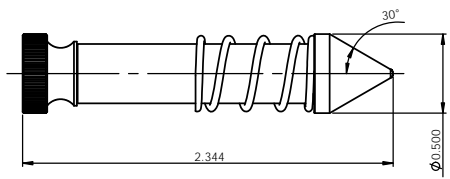

PrymeFix
fixturing solutions

155 PRAIRIE LAKE RD, SUITE A
EAST DUNDEE, IL 60118
847.428.7122

FILE NAME
I41-PRY-STD-002
DIRECTORY
P:\Manufacturing\PrymeFix Product Line\I11 Inserts\I41-PRY-STD-001 CENTERS INSERT\

PROPRIETARY AND CONFIDENTIAL

THE INFORMATION CONTAINED IN THIS DRAWING IS THE SOLE PROPERTY OF PRYMEFIX. ANY REPRODUCTION IN PART OR AS A WHOLE WITHOUT THE WRITTEN PERMISSION OF PRYMEFIX IS PROHIBITED.

1		UNLESS OTHERWISE SPECIFIED FRACTIONAL: ■ 003 ANGULAR: ■ 1/2 TWO PLACE DECIMAL: ■ 010 THREE PLACE DECIMAL: ■ 003 FOUR PLACE DECIMAL: ■ 0005 (REAM)	DRAWN BY: RD	DATE: 6/10/2014		
2			TITLE: ANVIL STYLE: 002			
3						
4			HEAT TREAT: N/A	No Pcs to Complete Order:		
5			MATERIAL: Alloy Steel (S5)			
6			FINISH: POLISHED	SIZE: B	DWG. NO: I42-PRY-STD-001 CENTERS INSERT TECHNICAL DRAWING	REV: 0
7			REVISION HISTORY	INCH UNITS	SCALE: 1:2	WEIGHT: 0.08

8	7	6	5	4	3	2	1
No. COMPONENTS IN ASSLY	OP1	OP2	OP3	OP4	OP5	OP6	
1							

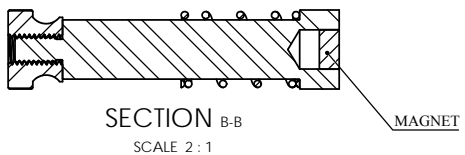
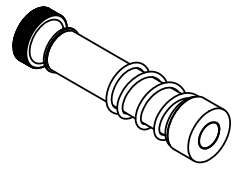
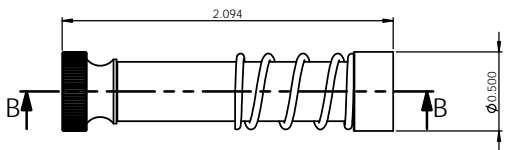

PrymeFix
fixturing solutions

155 PRAIRIE LAKE RD, SUITE A
EAST DUNDEE, IL 60118
847.428.7122

FILE NAME	M41-PRY-STD-007
DIRECTORY	P:\Manufacturing\PrymeFix Product Line\111 Inserts\M41-PRY-STD-001 CENTERS INSERT.V

PROPRIETARY AND CONFIDENTIAL

THE INFORMATION CONTAINED IN THIS DRAWING IS THE SOLE PROPERTY OF PRYMEFIX. ANY REPRODUCTION IN PART OR AS A WHOLE WITHOUT THE WRITTEN PERMISSION OF PRYMEFIX IS PROHIBITED.

1		UNLESS OTHERWISE SPECIFIED	DRAWN BY: RD	DATE	6/10/2014	
2				TITLE:		ANVIL STYLE: 007
3				SIZE		B
4				DWG. NO		M42-PRY-STD-001 CENTERS INSERT TECHNICAL DRAWING
5				REV		0
6				SCALE: 1:2	WEIGHT: 0.07	SHEET 3 OF 5
7				INCH UNITS		
REVISION HISTORY		HEAT TREAT	N/A	No Pcs to Complete Order:		
		MATERIAL	Alloy Steel (S5)			
		FINISH	POLISHED			

8	7	6	5	4	3	2	1
No. COMPONENTS IN ASSLY	OP1	OP2	OP3	OP4	OP5	OP6	

1

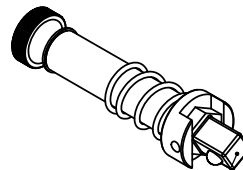
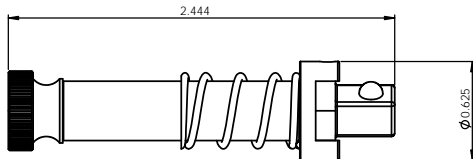

1/4" SQUARE DRIVE

PrymeFix
fixturing solutions

155 PRAIRIE LAKE RD, SUITE A
EAST DUNDEE, IL 60118
847.428.7122

FILE NAME
I41-PRY-STD-008

DIRECTORY
P:\Manufacturing\PrymeFix Product Line\I11 Inserts\I41-PRY-STD-001 CENTERS INSERT\

PROPRIETARY AND CONFIDENTIAL

THE INFORMATION CONTAINED IN THIS DRAWING IS THE SOLE PROPERTY OF PRYMEFIX. ANY REPRODUCTION IN PART OR AS A WHOLE WITHOUT THE WRITTEN PERMISSION OF PRYMEFIX IS PROHIBITED.

1		UNLESS OTHERWISE SPECIFIED	DRAWN BY: JO	DATE: 7/9/2018
2			TITLE: ANVIL STYLE: 008	
3			SIZE: B DWG. NO: I42-PRY-STD-001 CENTERS INSERT TECHNICAL DRAWING REV: 0	
4			SCALE: 1:2 WEIGHT: 0.08 SHEET 4 OF 5	
5		HEAT TREAT: N/A	No Pcs to Complete Order:	
6		MATERIAL: Alloy Steel (S5)		
7		FINISH: POLISHED		
REVISION HISTORY			INCH UNITS	

8	7	6	5	4	3	2	1
---	---	---	---	---	---	---	---

8	7	6	5	4	3	2	1
No. COMPONENTS IN ASSLY	OP1	OP2	OP3	OP4	OP5	OP6	
1							

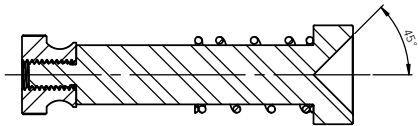
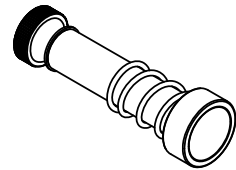
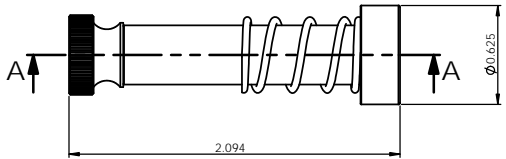

SECTION A-A
SCALE 2 : 1

PrymeFix
fixturing solutions

155 PRAIRIE LAKE RD, SUITE A
EAST DUNDEE, IL 60118
847.428.7122

FILE NAME	I41-PRY-STD-009
DIRECTORY	P:\Manufacturing\PrymeFix Product Line\I11 Inserts\I41-PRY-STD-001 CENTERS INSERT.V

PROPRIETARY AND CONFIDENTIAL

THE INFORMATION CONTAINED IN THIS DRAWING IS THE SOLE PROPERTY OF PRYMEFIX. ANY REPRODUCTION IN PART OR AS A WHOLE WITHOUT THE WRITTEN PERMISSION OF PRYMEFIX IS PROHIBITED.

1	UNLESS OTHERWISE SPECIFIED	DRAWN BY: RD	DATE: 6/10/2014
2		TITLE: ANVIL STYLE: 009	
3			
4		FRACTIONAL: ■ 003 ANGULAR: ■ 1:1 TWO PLACE DECIMAL: ■ 010 THREE PLACE DECIMAL: ■ 003 FOUR PLACE DECIMAL: ■ 0005 (REAM)	
5	HEAT TREAT: N/A	No Pcs to Complete Order:	
6	MATERIAL: Alloy Steel (S5)		
7	FINISH: POLISHED		
REVISION HISTORY		INCH UNITS	
		SCALE: 1:2	WEIGHT: 0.08
		SHEET 5 OF 5	

SIZE: B	DWG. NO: I42-PRY-STD-001 CENTERS INSERT TECHNICAL DRAWING	REV: 0
----------------	--	---------------