

8	7	6	5	4	3	2	1
No. COMPONENTS IN ASSLY	OP1	OP2	OP3	OP4	OP5	OP6	
1							

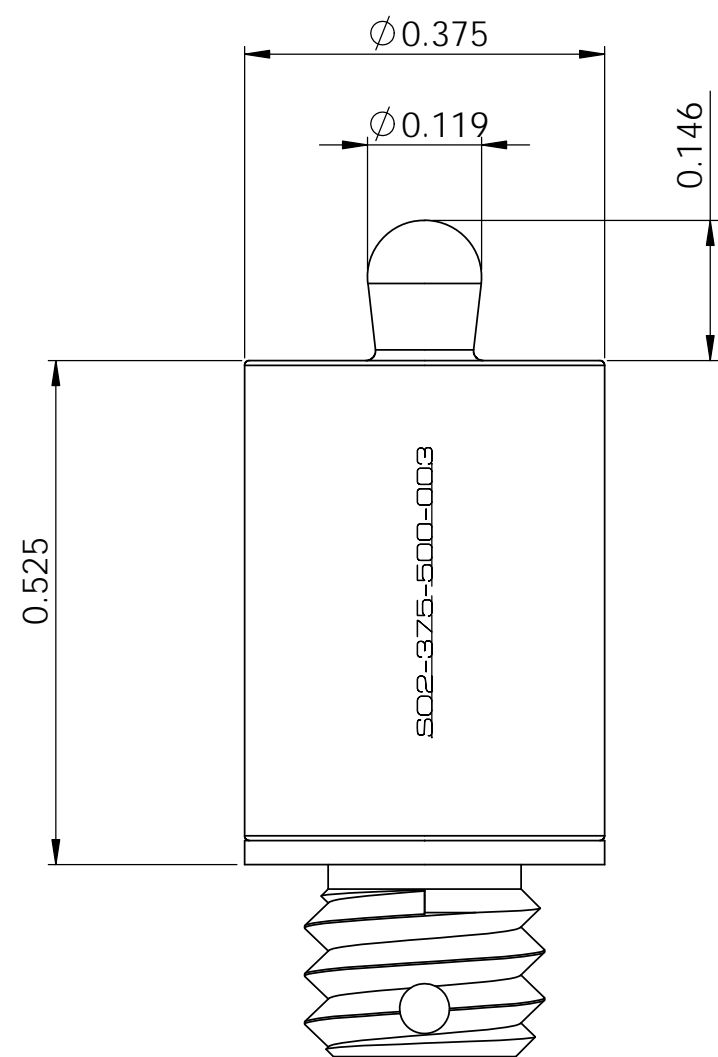

PLUNGER APPLIES FORCE TO PARTS

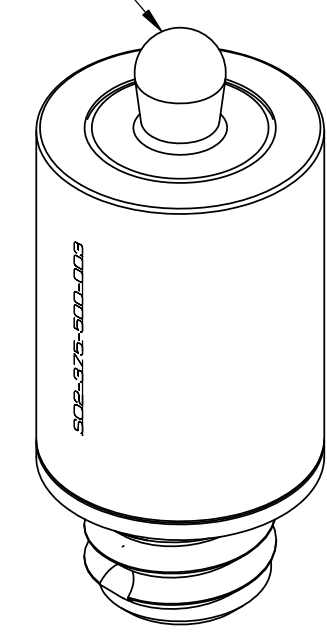

PrymeFix
fixturing solutions

155 PRAIRIE LAKE RD, SUITE A
EAST DUNDEE, IL 60118
847.428.7122

FILE NAME
SO2-375-500-003

DIRECTORY
P:\Manufacturing\PrymeFix Product Line\SO Standoffs & Kits\SO2 M4 Kits\

PROPRIETARY AND CONFIDENTIAL

THE INFORMATION CONTAINED IN THIS DRAWING IS THE SOLE PROPERTY OF PRYMETECH. ANY REPRODUCTION IN PART OR AS A WHOLE WITHOUT THE WRITTEN PERMISSION OF PRYMETECH IS PROHIBITED.

1		UNLESS OTHERWISE SPECIFIED	DRAWN BY: RD	DATE 10/9/2013
2			TITLE: SO2-375-500-003 SPRING PIN STANDOFF 3/8" OD x 1/2" L	
3		FRACTIONAL ± .003 ANGULAR: ± 1.0 TWO PLACE DECIMAL ± .010 THREE PLACE DECIMAL ± .003 FOUR PLACE DECIMAL ± .0005 (REAM)	SIZE DWG. NO. REV	
4			B SO2-PRY-STD-001 TECHNICAL DRAWINGS 0	
5		HEAT TREAT N/A	No Pcs to Complete Order:	
6		MATERIAL 6061 Alloy	SCALE: 10:1 WEIGHT: 0.01 SHEET 11 OF 13	
7		FINISH BLACK ANODIZED		
REVISION HISTORY		INCH UNITS		