

8	7	6	5	4	3	2	1
No. COMPONENTS IN ASSLY	OP1	OP2	OP3	OP4	OP5	OP6	

1

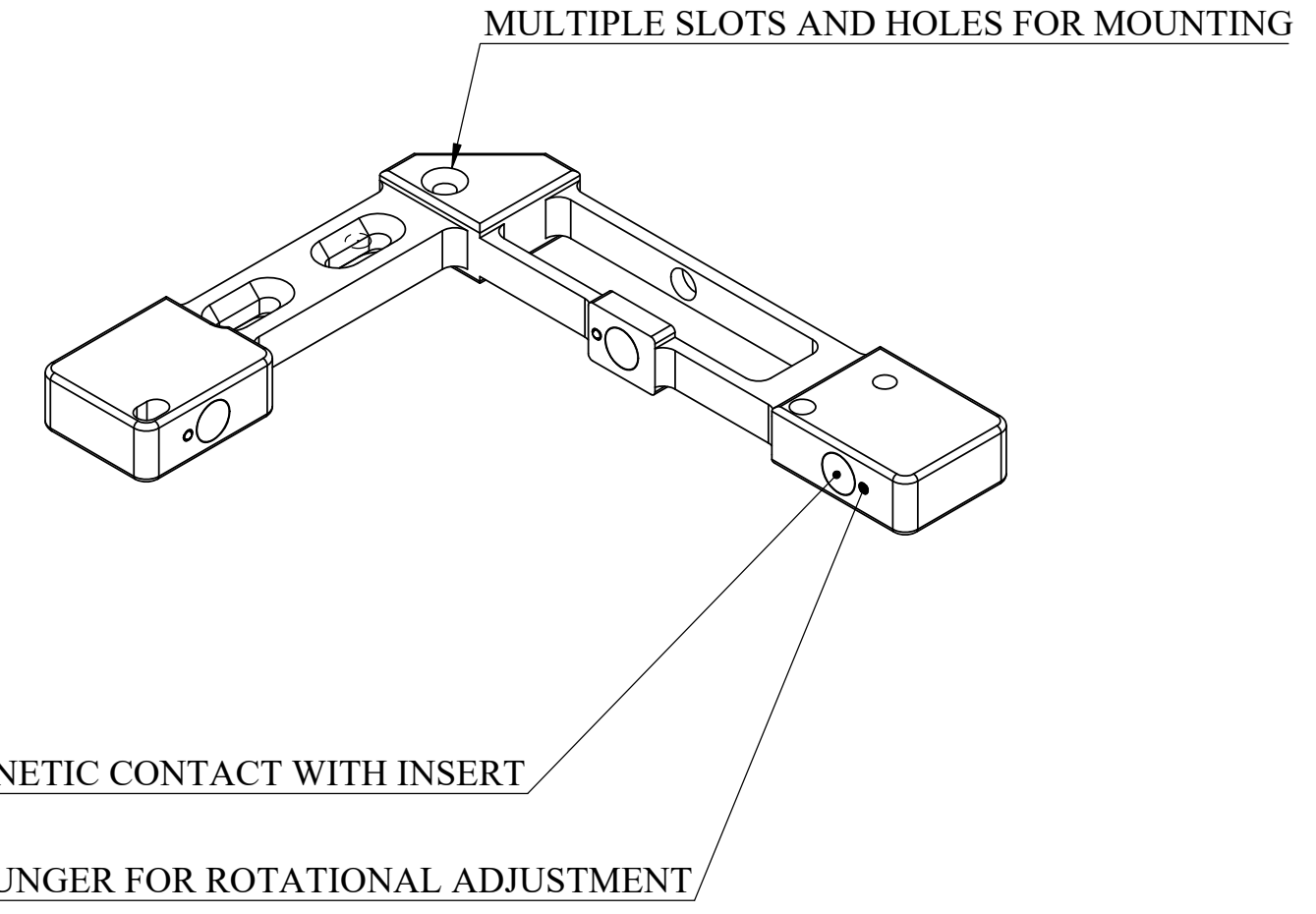
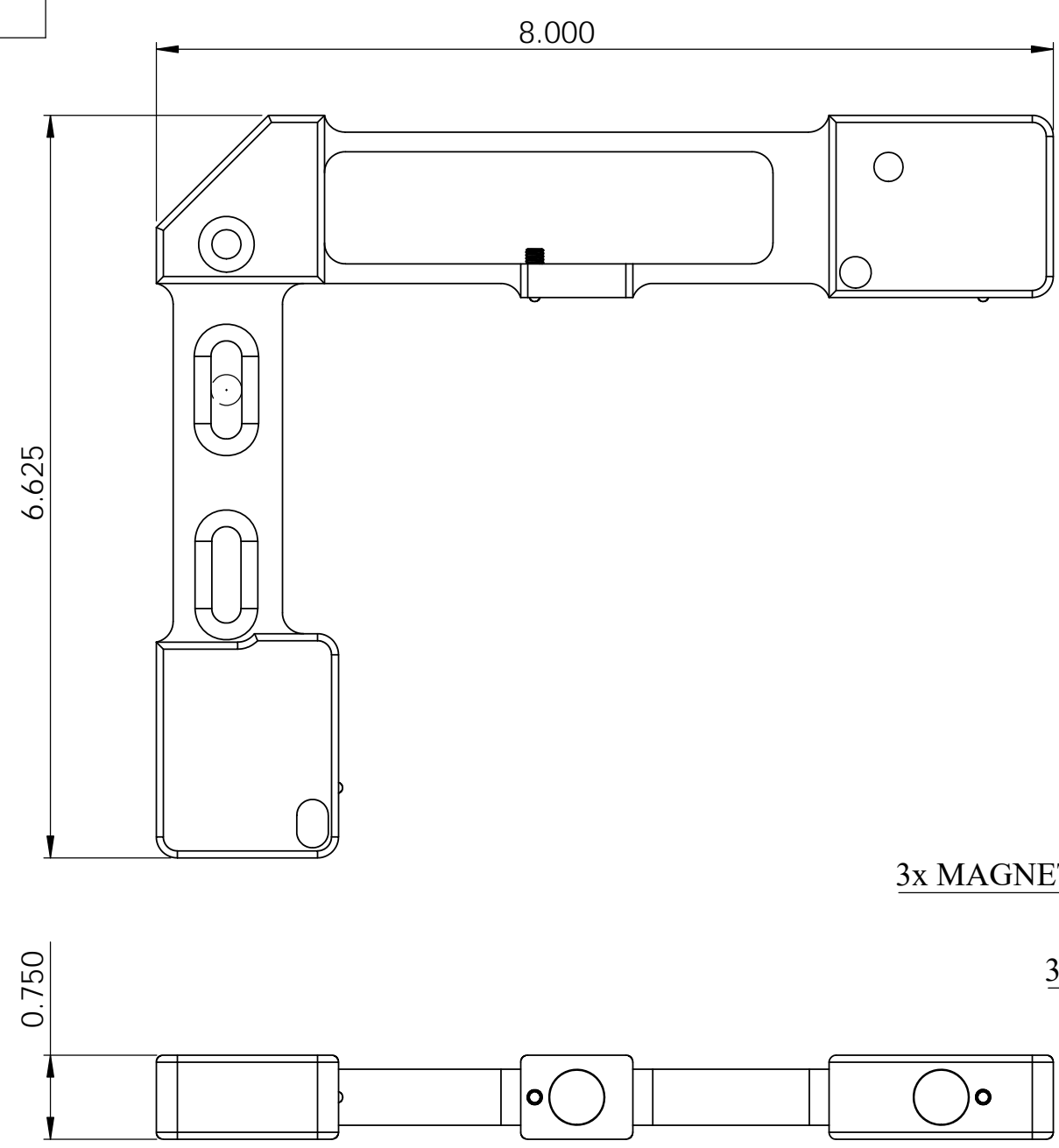

**PrymeFix**  
fixturing solutions

155 PRAIRIE LAKE RD, SUITE A  
EAST DUNDEE, IL 60118  
847.428.7122

FILE NAME  
N11-OGP-SSF-300300

DIRECTORY  
P:\Manufacturing\PrymeFix Product Line\C11 & N11 Corner Inserts & Nests\N11-OGP-SSF-300300\

**PROPRIETARY AND CONFIDENTIAL**

THE INFORMATION CONTAINED IN THIS DRAWING IS THE SOLE PROPERTY OF PRYMETECH. ANY REPRODUCTION IN PART OR AS A WHOLE WITHOUT THE WRITTEN PERMISSION OF PRYMETECH IS PROHIBITED.

1	ADDED M6 THRU HOLES FOR RAM 300 PLATFORM	UNLESS OTHERWISE SPECIFIED	DRAWN BY: <b>RD</b>	DATE: <b>8/19/2013</b>	
2			TITLE: <b>300300 CORNER NEST</b>		
3					
4			FRACTIONAL $\pm .003$ ANGULAR: $\pm 1.0$ TWO PLACE DECIMAL $\pm .010$ THREE PLACE DECIMAL $\pm .003$ FOUR PLACE DECIMAL $\pm .0005$ (REAM)		
5			HEAT TREAT <b>N/A</b>	No Pcs to Complete Order:	
6			MATERIAL <b>6061 Alloy</b>	SIZE <b>B</b>	DWG. NO. N11-OGP-SSF-300300 PRINTS
7			FINISH <b>G&amp;M GREY POWDERCOAT</b>	REV <b>1</b>	
REVISION HISTORY		INCH UNITS	SCALE: 1:10	WEIGHT: 0.77	
			SHEET 5 OF 5		